



SPECIFICATION SHEET
03SLHF24SSC

DESCRIPTION: **3" LONGITUDINALLY SLOTTED
STAINLESS STEEL GRATE**

WRITTEN SPECIFICATION:

Grating shall be 03SLHF24SSC, as manufactured by Eric'sons, 296 Industrial Blvd. N., Dallas, GA 30132, (770) 505-6575. Grating shall have ADA compliant and heel proof longitudinal slots. The grate shall be made of grade T304 stainless steel per ASTM A-240. The grate surface shall have a bead blast finish. The grate shall be 2 7/8" wide x 24" long x 1/2" thick and have a minimum load rating of DIN Class C (exceeds H-20/HS-25).

- NOTES**
1. GRATES MAY BE MANUFACTURED TO REQUIRED RADII
2. ADA COMPLIANCE DEPENDS ON DIRECTION OF TRAVEL

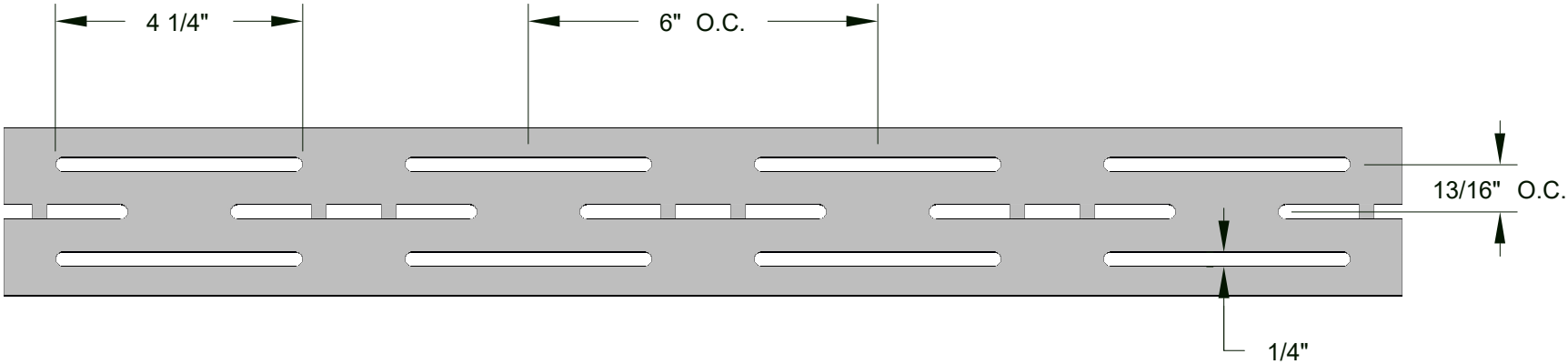
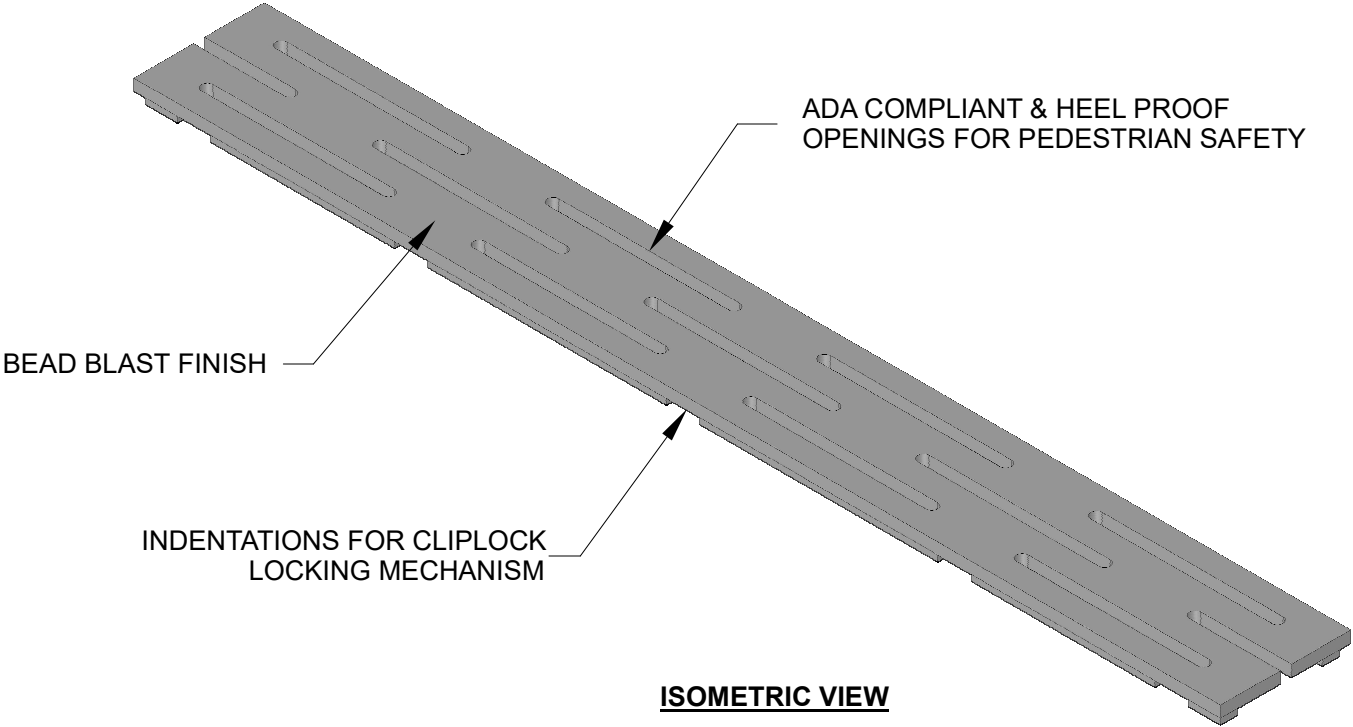

TOP VIEW

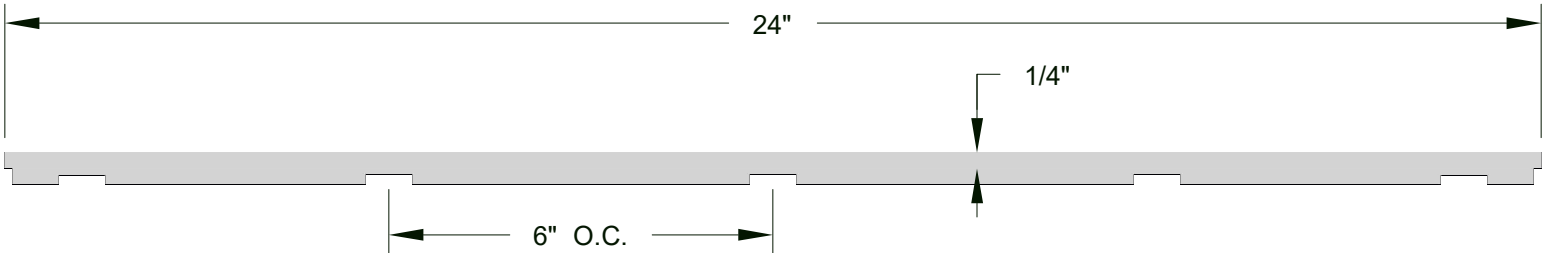

SIDE VIEW

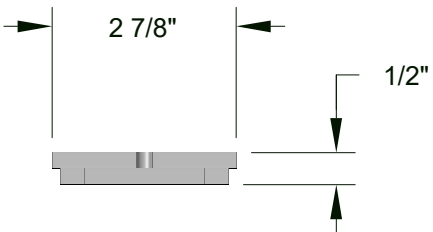

END VIEW

<u>PRODUCT DATA</u>	
MATERIAL:	T304 STAINLESS STEEL
FINISH:	BEAD BLAST
ADA COMPLIANT:	YES
HEEL PROOF:	YES
LOCKING DEVICE:	CLIPLOCK
WEIGHT (LB):	5.5
OPEN AREA (IN²/LF):	6.04
<u>LOAD RATINGS</u>	
DIN / EN1433:	CLASS C
AASHTO:	EXCEEDS M-306, H-20, & HS-25
ASME:	MEDIUM DUTY
FAA:	NO
LOAD CAPACITY:	1,160 PSI
PHONE: 770-505-6575	MODEL BY: LRC
296 INDUSTRIAL BLVD. N. DALLAS, GA 30132 222 WEST 33RD ST. OGDEN, UT 84401 13300 RAMBLEWOOD DR. CHESTER, VA 23836	DRAWING BY: EV
	REVIEWED BY: LRC
	DATE: 07/03/2024
	SCALE: 1 : 3
	REV # : IC-0

WWW.DURATRENCH.COM

- TOLERANCES**
.X = ±0.1
.XX = ±0.04
.XXX = ±0.004
FRACTIONAL = ± 1/16"
ANGULAR = ± 0.5°