



SPECIFICATION SHEET
12SBAF24SSC

DESCRIPTION:
12" SLOTTED STAINLESS STEEL GRATE

WRITTEN SPECIFICATION:

Grating shall be 12SBAF24SSC slotted grate. The grate shall be made of T304 stainless steel. The grate shall have a bead blast finish. The grate shall be 12" wide x 24" long x 1 1/2" thick and have a minimum load rating of DIN Class C (Exceeds H-20/HS-25).

PRODUCT DATA

MATERIAL:	T304 STAINLESS STEEL
FINISH:	BEAD BLAST
ADA COMPLIANT:	YES
HEEL PROOF:	NO
LOCKING DEVICE:	CLIPLOCK
WEIGHT (LB):	37.2
OPEN AREA (IN²/LF):	48.3

LOAD RATINGS

DIN / EN1433:	CLASS C
AASHTO:	EXCEEDS M-306, H-20, & HS-25
ASME:	MEDIUM DUTY
FAA:	NO
LOAD CAPACITY:	967 PSI

PHONE: 770-505-6575	MODEL BY:	LRC
296 INDUSTRIAL BLVD. N. DALLAS, GA 30132 222 WEST 33RD ST. OGDEN, UT 84401 13300 RAMBLEWOOD DR. CHESTER, VA 23836	DRAWING BY:	KM
	REVIEWED BY:	JDP
	DATE:	12/18/2024
	SCALE:	1 : 4.5
	REV # :	IC-0

WWW.DURATRENCH.COM

- NOTES
- GRATES MAY BE MANUFACTURED TO REQUIRED RADII
 - ADA COMPLIANCE DEPENDS ON DIRECTION OF TRAVEL

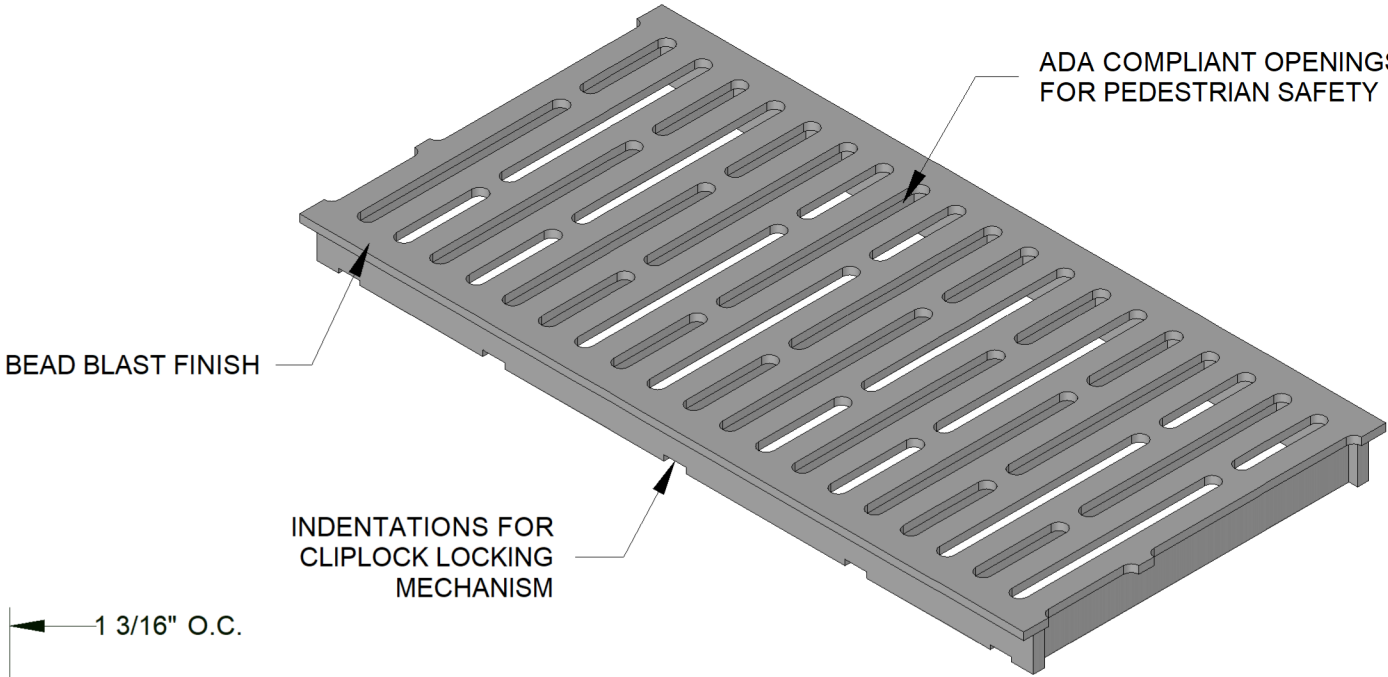

ISOMETRIC VIEW

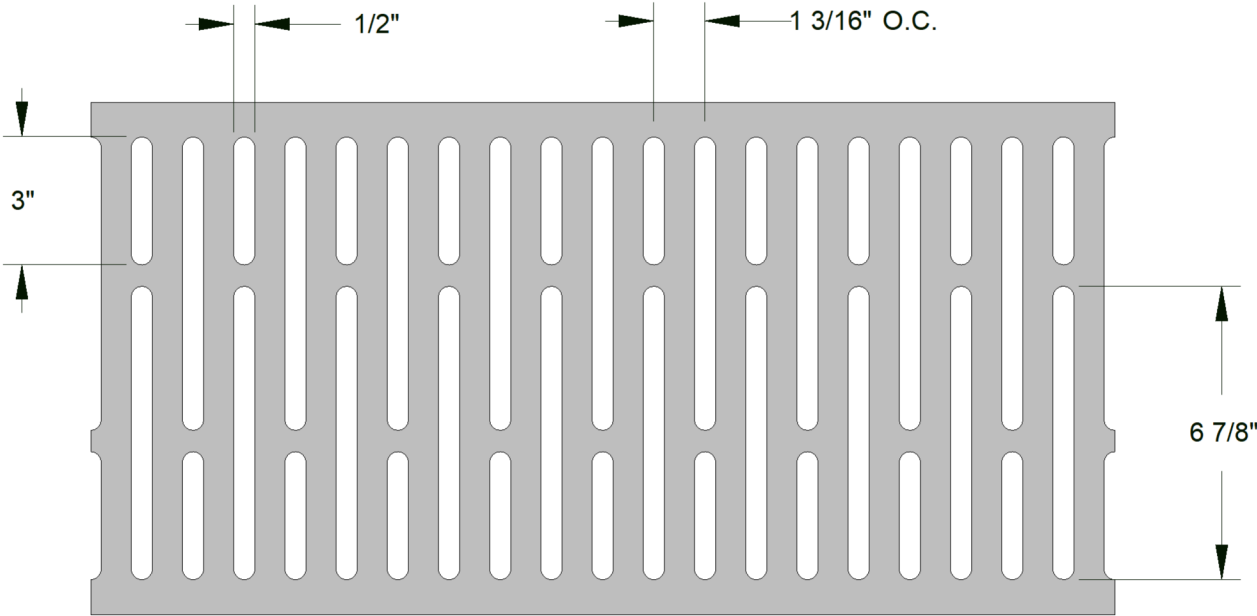

TOP VIEW

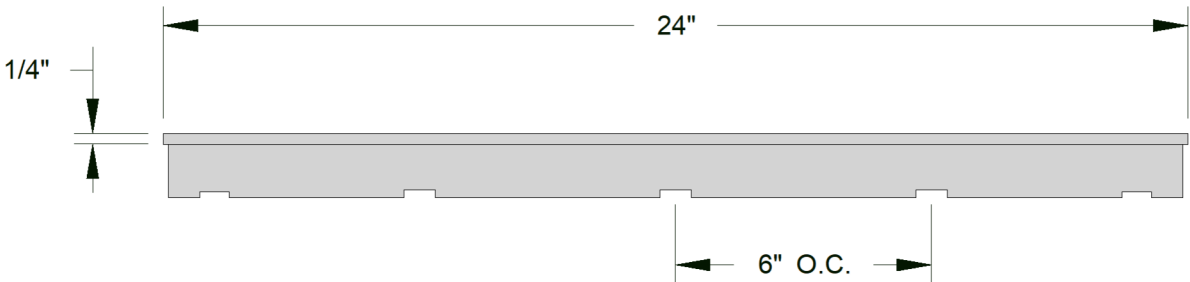

SIDE VIEW

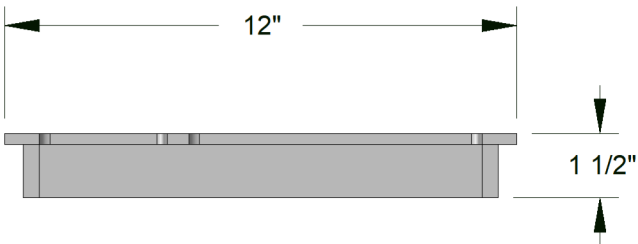

END VIEW

TOLERANCES
.X = ±0.1
.XX = ±0.04
.XXX = ±0.004
FRACTIONAL = ± 1/16"
ANGULAR = ± 0.5°